

ACCEPTABLE MASKS FOR PATIENTS, STAFF AND VISITORS

All patients, staff and visitors are required to wear a mask while in the office.

ACCEPTABLE MASKS



N95 MASKS WITHOUT VENTS

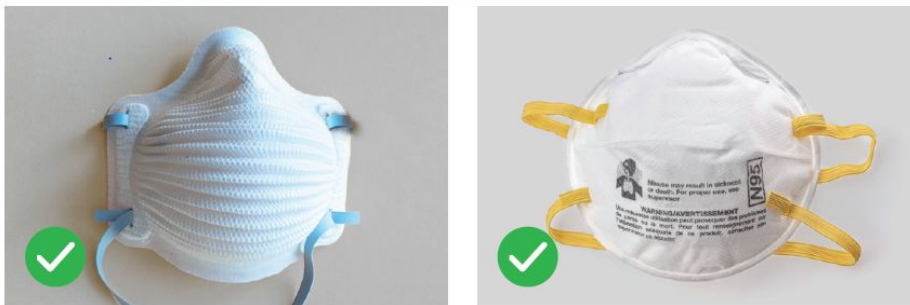

UNACCEPTABLE MASKS



Why? Masks with vents/exhalation valves allow unfiltered exhaled air to escape. This is an unacceptable form of source control as a universal mask.